

Wireless Pet-immunity PIR Detector

The wireless pet-immunity PIR detector adopts double infrared sensor technology, which can avoid false alarm caused by pet and improve stability greatly. Please read the user manual carefully before use.

I Component Description>>>>

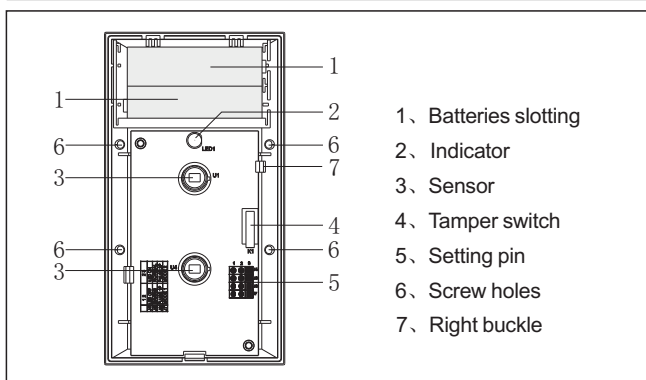

II Main Features>>>>

- * Pet immunity with the signal from the double sensor.
- * Improve the stability greatly based on analyzing the signal of dual symmetrical element & microprocessor.
- * Automatic temperature compensation.
- * Anti-white light function.
- * Anti-magnetic interference with counting pulse sensitivity
- * Wireless signal output

III Technology Parameter>>>>

Working Voltage	DC3V (2 pieces of 5# battery)
Working Current	≤80uA
Time of Alarm Blocking	60s
Pet-immunity	35kg
Working Temperature	-10℃~+50℃
Installation Mode	Wall/Ceiling mounted
Detective Angle	110°
Detective Distance	12m
Wireless frequency	433.92MHz
Wireless distance	300m
Tamper switch	N.C

IV Chart of Detective Range:>>>>

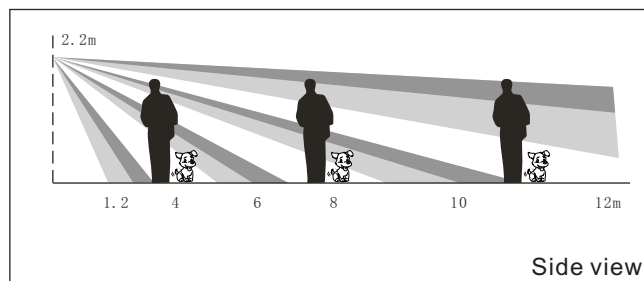
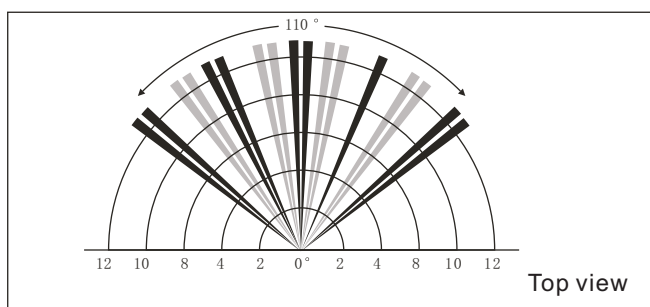

V Installation Requirements of Wall-mounting Installation (without bracket)

1. The infrared detector has the highest sensitivity when a human body moves horizontally relative to the lens and the lowest when vertically against the lens. The installation height should be about 2 meters. The part with indicator should be installed upwards.
2. Stand off the warm or cold sources, such as air-conditioner, fan, refrigerator or oven, and avoid sunshine.
3. Make sure that there is no barrier within the defended area of the detector.
4. Open the shells via the rectangular holes with a screwdriver, and take down the PCB, and then disclose the line holes.
5. If the PCB needs to be removed, please make operation as below: take the plug out, and then carefully pull the right buckle (7) with the right thumb and the setting pin (5) with the left thumb.

VI Usage of the product>>>>

1. Set working modes based on your demands:
 - LED ON/OFF** selection J4: It indicates the status when the system alarms. LED (ON/OFF) does not affect the normal running of the detector. The default setting is on the position of ON (2, 3).
 - SAVING / NORMAL** selection J5: It is to set the detective way of PIR.
 - SAVING is for energy saving (1, 2): If the people enter the detective area and keep moving continuously. The infrared detector sends one signal at first trigger only. The infrared detector won't send new signal while trigger after 10 seconds immovability.
 - NORMAL is for energy normal (2, 3): when there is trigger at one time, the sensor will block itself for 10 seconds. The sensor doesn't make effect by PIR signal in the 10 seconds. The default setting is NORMAL.
 - PULSE** selection J6: It is used for setting sensitivity of the detector.
 - 1P is Mono-pulse mode (1, 2): This mode is used in general environment
 - 2P is Double-pulse mode: With more anti-jamming ability, this mode is used in the poor environment. The default state is 2P.
- Note: After changing the setting of alarm output mode, or sensitivity of the detector, user shall restart the detector to activate the settings.**
- “Mode” selection is not allowed to change. “2, 3” is for default.**
- After accomplishment, please put two pieces of 5# batteries into the batteries slotting. **When the indicator is flashing, the detector can start to work.**

3. Turn on the power. After 60s of alarm blocking time, the indicator is off. The detector begins to detect.
4. User shall move horizontally at 6m distance to trigger the detector for testing.

VII Chart of Bracket installation>>>>

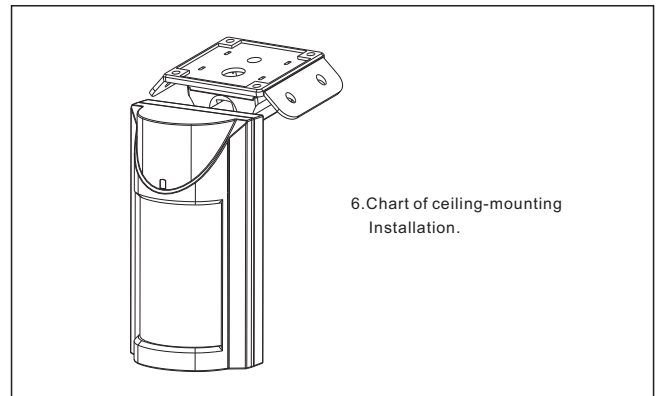
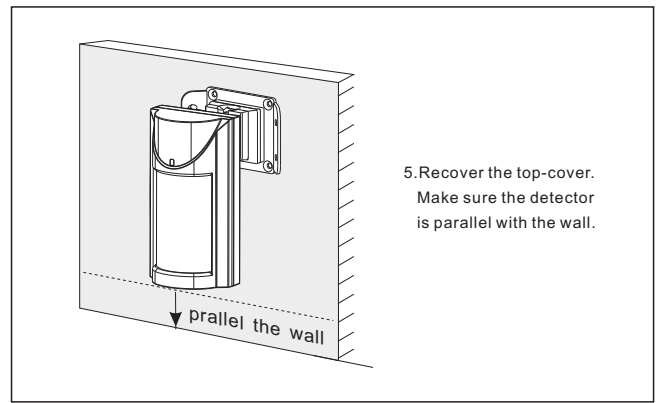
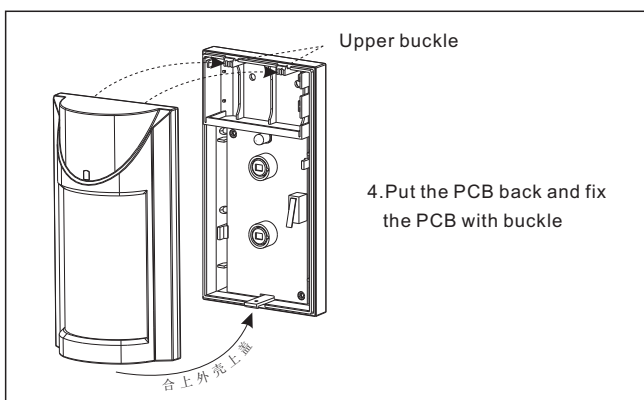
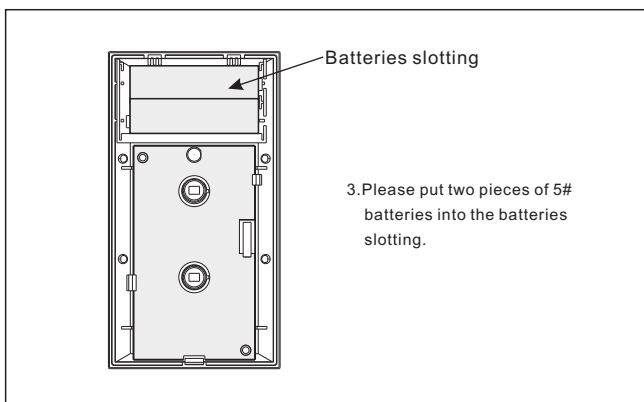
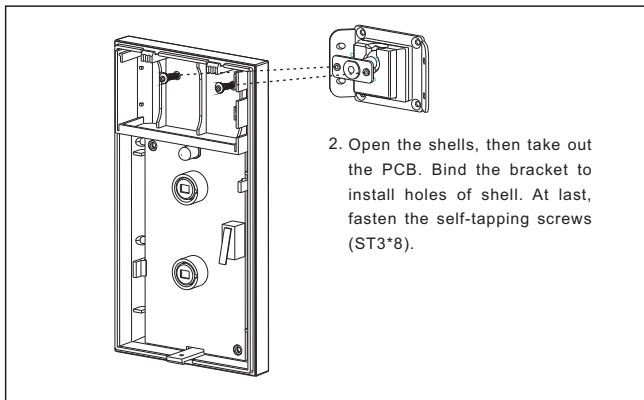
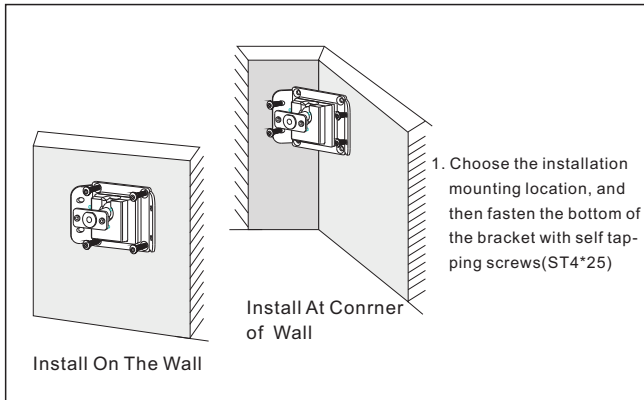

VIII Install on Wall>>>>

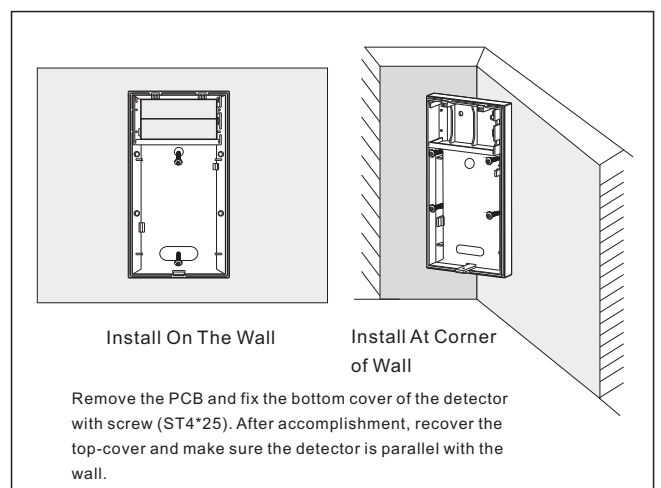

IX Warning

1. Please install and use the detector as the above requirement. Do not touch the surface of the sensor, or the sensitivity of the detector would be reduced. If it needs to be cleaned, please cut off the power and clean it with soft cloth and alcohol.
2. **During the time of alarm recovery and self-blocking, the sensor doesn't make effect.**
3. Avoid the changeful environment which would cause false alarm.
4. This detector can reduce the occurrence of incidents, but nothing can be foolproof all the time. So for your safety, please keep vigilance and security consciousness in mind all the time.